

AV-iPH

Converts the DOCK to RCA level audio and composite video

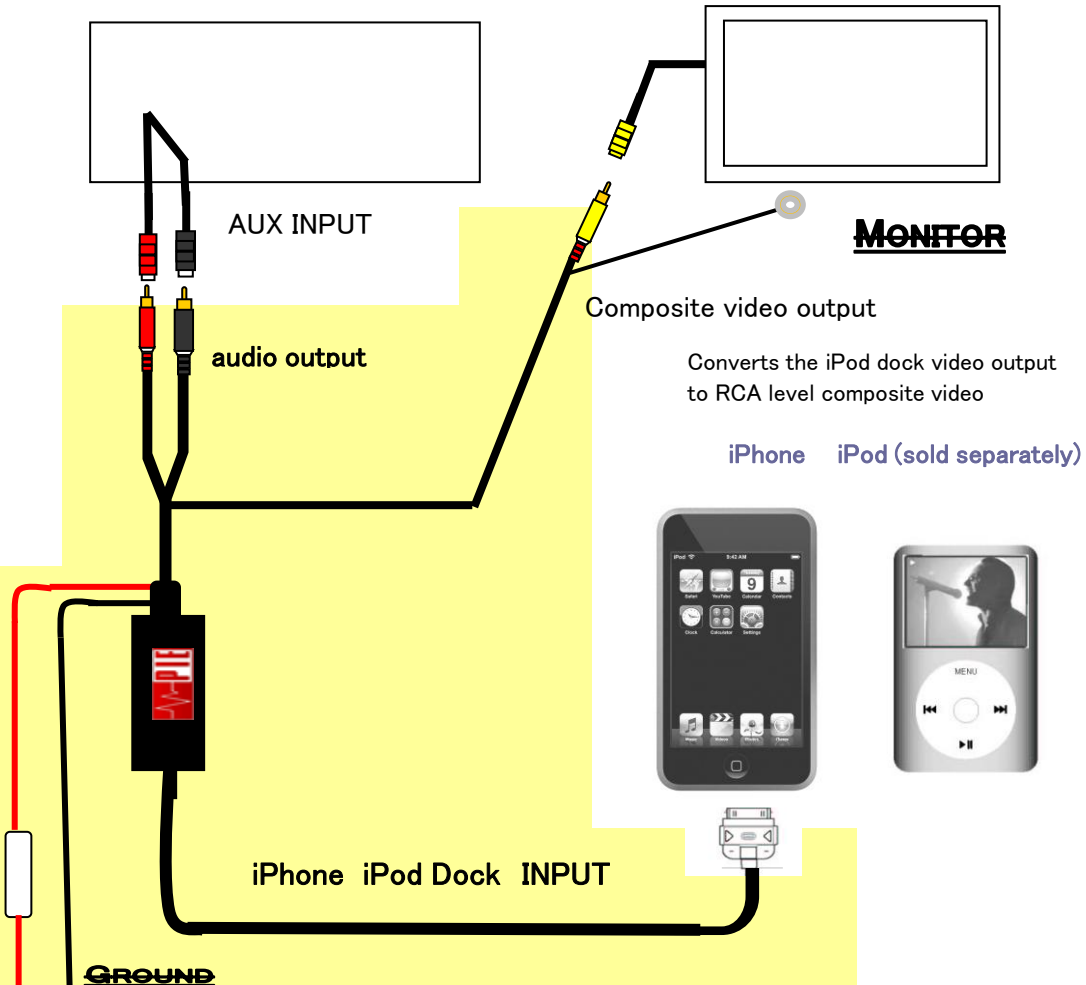

Mobile AV Equipmente



+12V ACC
Needs to connect for charging iPhone/iPod

Note: The "TV OU" setting on the iPods must be set "ON" or "ASK" for the video output to work. It is not necessary for the iPod touch or iPhone.

- Feature** Converts the iPhone/iPod audio and video output (dock) to RCA level audio and composite video.
- * The AV-iPH does not have the capability to control any of the iPhone/iPod function.
 - * Volume level is controlled by the OEM or aftermarket AV equipment.
- Wiring** Connects Red wire to +12V ACC and Black wire to Ground respectively, for charging while iPhone/iPod playing.

iPhone4 3G(S) 3G touch(ALL) classic(ALL) video Nano(ALL) Mini Color G4

AV—iPH VIDEO OUTPUT APPENDIX

Please refer to the following operation procedure since there are something differences on the iPhone or iPods (touch, classic, Nano: 3rd, 4th and 5th).

Operation for all models

The TV out on the iPods must be set "ON" for video output to work. If not, the video output does not work. It is not necessary for this operation on the iPod touch and iPhones.

TV OUTPUT: ON
TV SIGNAL: NTSC (in Japan)

Operation for classic and Nano

Appendix Operation

(1) If the iPod is turned to OFF by pressing the Turn ON/OFF button:

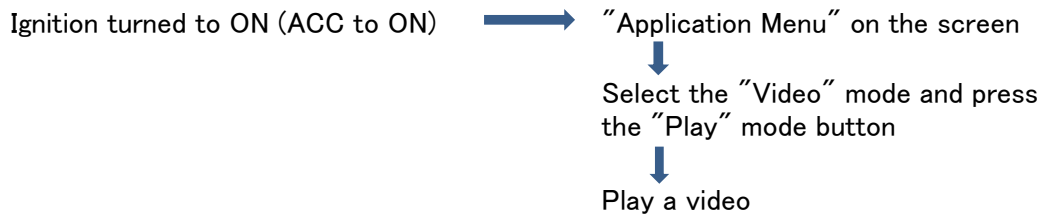

(2) If the iPod is turned to OFF by itself:

(The iPod is turned to OFF after the "Pause" position is kept for two minutes.)

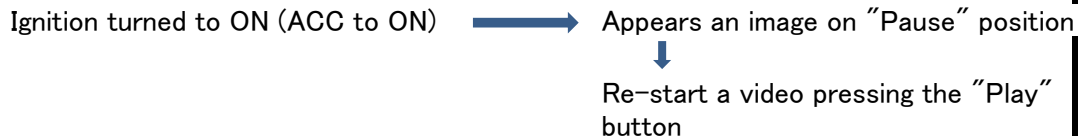

Operation for iPod touch and iPhones

■ If select the "Video mode" of the iPod, the iPod plays a selected video only, do not play any other video source continuously. This is iPod's capability.
(If use an iPhone 3G, it plays the video continuously until the "Play" mode is turned to "OFF".

■ If select a music video in the "Play list" of the "Video mode" or a music video installed into the the "music play list", the iPod plays the video sources continuously by its capability.

AV-iPH Video Noise Appendix

Some radios or AV equipments do not have their video ground connected to the radio's or AV equipment's chassis ground.

In these case, there are something "noise" on the video or "spin noise" of the iPod classic or nano.

If there are something "noise" on the video, this ground wire needs to be attached to radio chassis for optimum video quality.

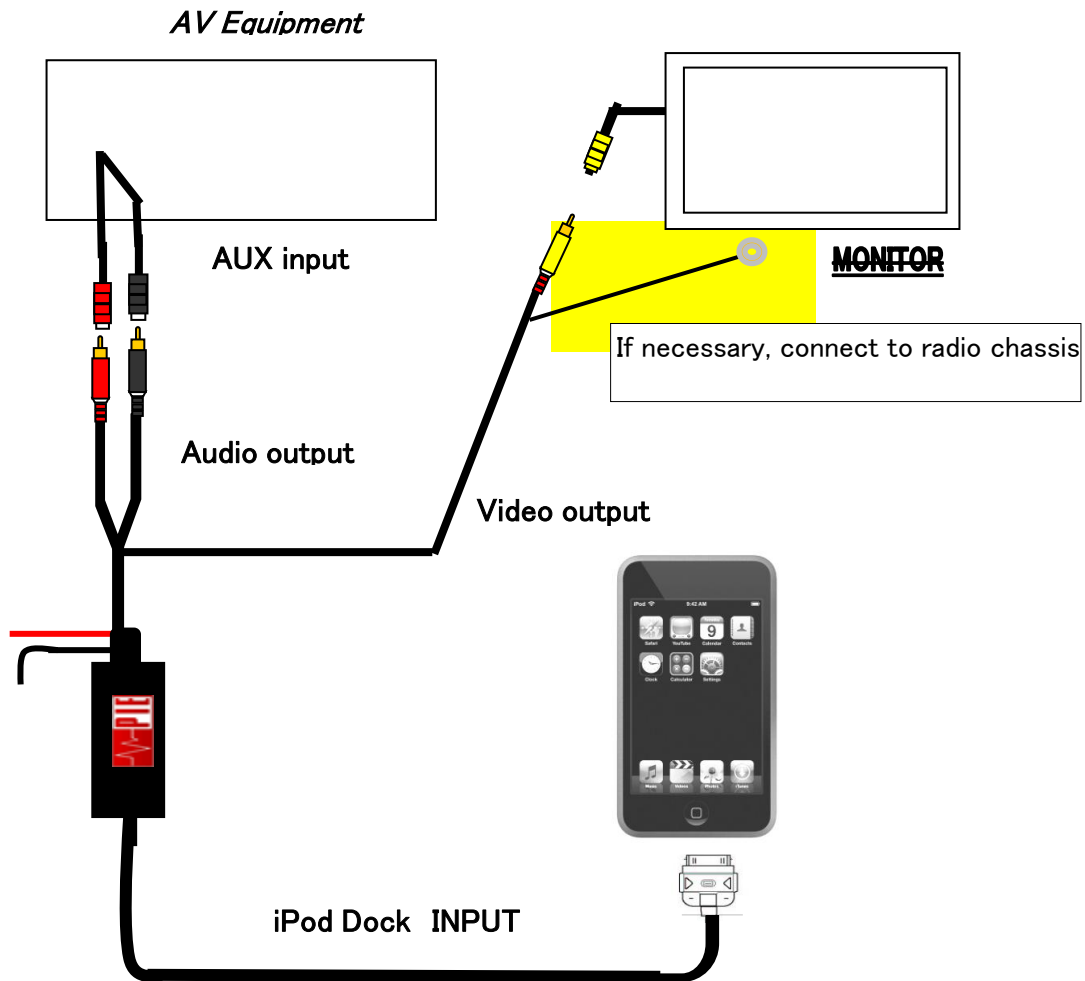

Note: If there is no noise issue with video quality, this ground wire does not need to be connected.